

Apr 30 1900

a.

B. Stone in grade

c.

D.

E.

F.

G.

H.

I. No cor established line only

J. H. Hoolstene craft

"B" Located field stone 1-6" below gravel surface July 9, 1973;

Placed 12" steel pin above; R.P. N&C, Cor Post SW 59⁶⁹; R.P.

N&C, P.P. NW 59⁶⁴; R.P. N&C, Cor. Post NE. 59⁸⁸

"I" Located field stone 1.4' below gravel surface July 10, 1973; placed

steel pin above; R.P. N&C. Sign Post West 48²⁰; R.P. N&C, P.P. SW;

68²⁵; R.P. Yield sign post N&C. E. NE. 85⁷⁸

30
31
32
33
34
35

SURVEY No. _____

Section 31 Town 10 S Range 10

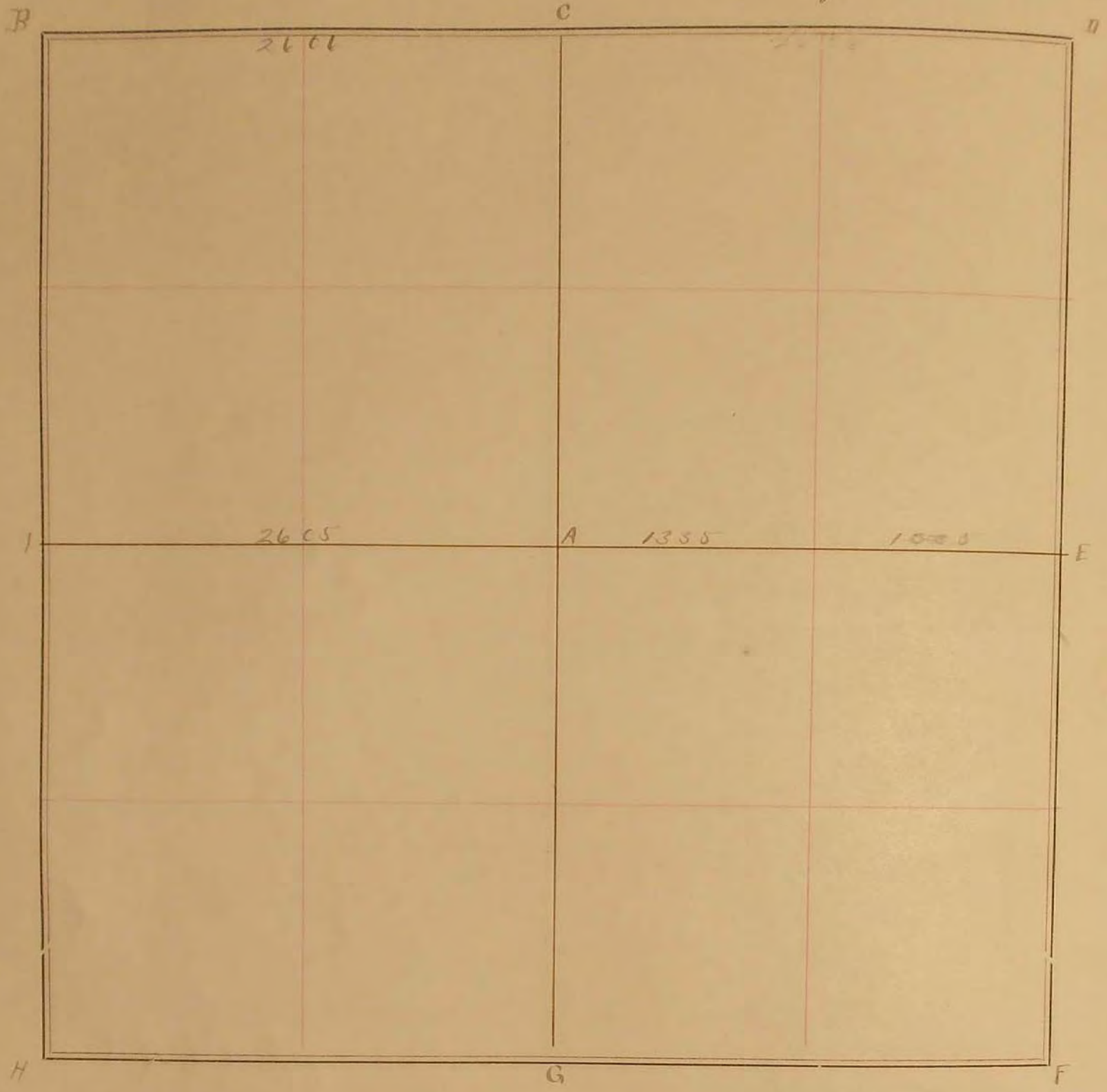

FIELD NOTES.

Apr. 30, 1900,

- A
- B
- C
- D
- E
- F
- G
- H
- I

see sketch

SURVEY No. _____

Section *31* Town *105* Range *40*

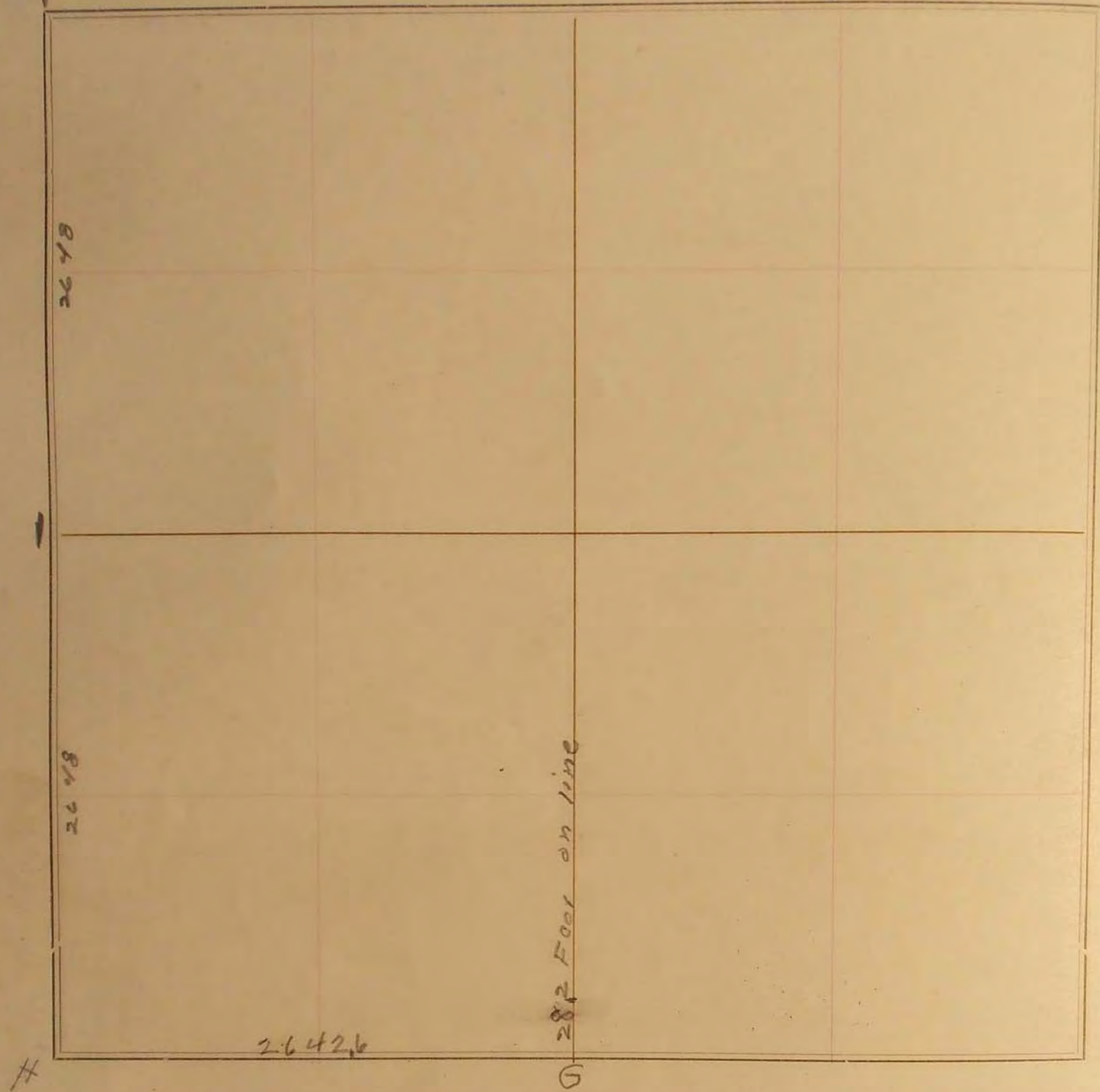

FIELD NOTES.

B stone in grade

H no cor. established, line only